

How to use the sensor:

Place the big sensor in line of sight to the remote control. Avoid placing the big sensor near to a plasma TV as these TVs emit IR frequency which might cause interference.

Peel off the adhesive tape behind the small sensor and paste it on the sensor point of the a/v equipment which you want to control.

Power up the adaptor. The LED will light up green when power is connected and flash red when the big sensor receives a signal from the remote control.

The TV Sensor allows you to remote control any audio/video components hidden in cabinets, behind a wood panel or even placed in another room. At an operating frequency range of 34 khz-60 khz, these IR repeaters can be powered by a USB port, USB dcs5v adaptor.

Simply stick the small sensor to the IR sensor of your equipment and ensure that the big sensor is in line of sight with your remote control. Power up and you are ready to enjoy using the remote control without any problems.

For even better results, you should use an external power adaptor that is 5V - 1AMP to power this device.



Small Sensor

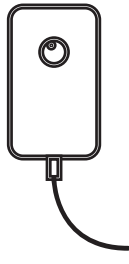

Big Sensor

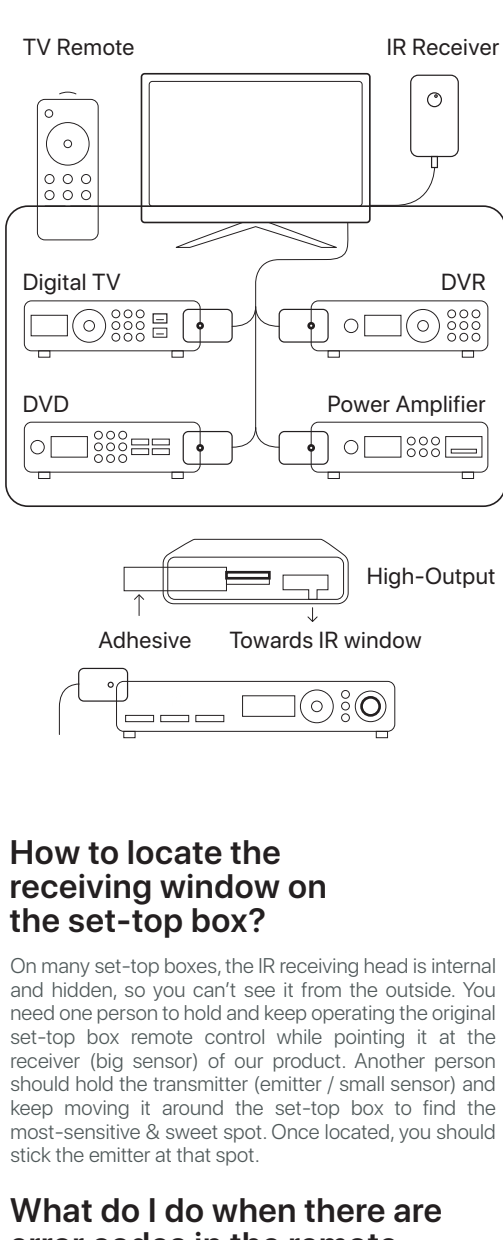

How to locate the receiving window on the set-top box?

On many set-top boxes, the IR receiving head is internal and hidden, so you can't see it from the outside. You need one person to hold and keep operating the original set-top box remote control while pointing it at the receiver (big sensor) of our product. Another person should hold the transmitter (emitter / small sensor) and keep moving it around the set-top box to find the most-sensitive & sweet spot. Once located, you should stick the emitter at that spot.

What do I do when there are error codes in the remote control?

Please check if the receiver of our product is disturbed by the TV screen or an energy saving lamp. If so, please keep the receiver away from these.

Please check the position of the receiver. The place where the signal light is located in the remote control receiving window. The receiving angle of the receiver's remote control signal is 45. When the remote control is operated, please aim the remote control directly at the receiving window of the receiver.

Why does the remote control not work after installation?

This could be due to a variety of reasons like the distance being short or the remote control signal not being sensitive enough, etc.. You will need to check them one by one.

Please check if the remote control of the original set-top box is running normally or if the battery is dead.

When using our products, you will need to hide the set-top box to avoid the set-top box receiving two infrared signals at the same time. Otherwise, because of the time difference between the two infrared signals, they will conflict with each other as they are not synchronized, which may cause failure.

Please check if the light on the receiver (big sensor) flashes when the original set-top box remote control is aimed at the receiver and operates. If the signal light flashes red, the product is working properly. The signal will flash when the receiver has received and transmitted the infrared signal. At this point, please check if the transmitter is attached to the receiving window of the set-top box close enough. Our transmitter sends the signal directionally and you must properly attach the transmitter to the receiving window of the set-top box.

Only one transmitter can be attached to one home appliance, and multiple transmitters cannot be attached to one home appliance, otherwise, they will interfere with each other. Please hide the extra transmitter/s. Wires for two transmitters are detachable. Please place the receiver away from the screen border of the plasma TV. Some TV plasma screens and CCFL screens emit an infrared signal that interferes with the receiver.

For Additional Information

Contact Us

Tech Support : +91 261 3500 419

Call Us : +91 261 3500 400

support@whitelion.in

www.whitelion.in